

The pneumatic table T.H.350 is an essential part of rotary transfer machines for machining operations, or any other purpose.

The plate's drive is via double rack and pinion device and front gears coupling ensure a proper movement of the required load.

**The plate is accurately positioned by two, 250mm (9.84") diameter, 120 teeth, hardened and ground HIRTH gears rings, for high stability against all strains on the plate (torque).**

When stationary, the plate's HIRTH gears are firmly held engaged by a high pneumatic axial thrust to ensure maximum rigidity.

Plate indexes after lifting 4mm (.157")

**Number of indexings / rev. is set by means of an external setting wheel (max. 6 options).**

Table configurations:

- quick station change =T.H.350
- station change with distance pieces =T.H.345

On model T.HPE.350, start of the table must be done through one 5/2 double solenoid valve.

On model T.HPE.345, start of the table must be done through two 5/2 double solenoid valve.

Table is also available in a totally pneumatic version (model T.HPP.350).

Please note the range of our standard accessories on the next page. The table is prearranged for emergency stop control.

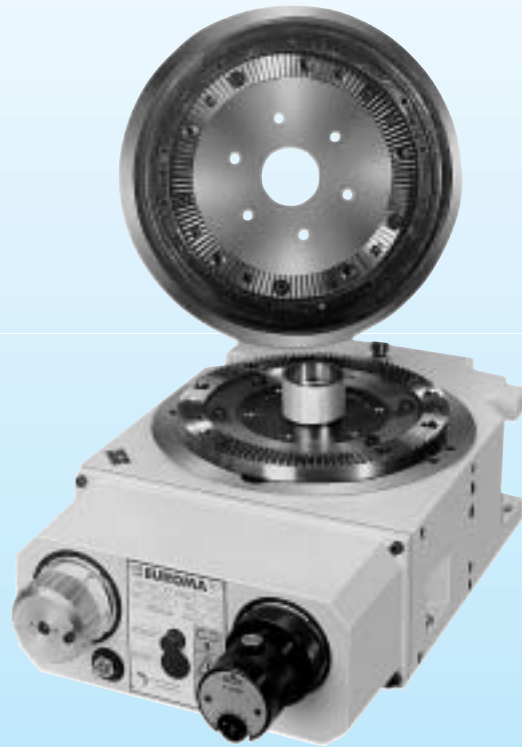

TECHNICAL FEATURES	
PLATE O/DIAMETER mm (inch)	320 (12.60")
DIRECTION OF ROTATION	CLOCK WISE
ANGULAR INDEXING ACCURACY	± 5"
INDEXING ACCURACY ON PLATE O/DIA mm (inch)	± 0.004 (± .00016")
PLATE TO BASE PARALLELISM mm (inch)	0.02 (.0008")
PLATE FLATNESS mm (inch)	0.02 (.0008")
PLATE LOCKING FORCE AT 6 bar (87 P.S.I.)	15800 N (3488 lbs)
PLATE DRIVING TORQUE AT 6 bar (87 P.S.I.)	100 Nm (74 ft.lb)
MAX MOMENT OF INERTIA kgm <sup>2</sup> (ft <sup>2</sup> .lb)	20 (474)
WEIGHT Kgs (lbs)	88 (194)
STANDARD COLOUR-RAL	7035

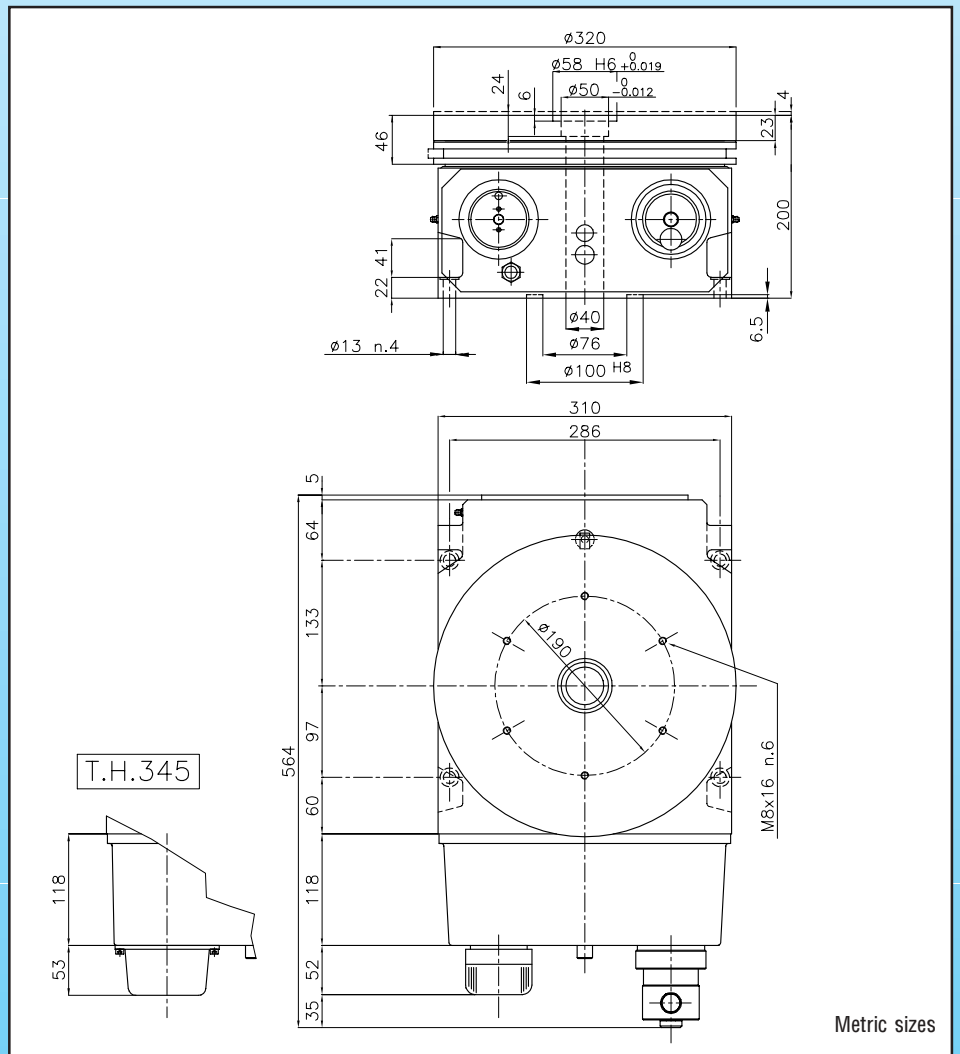
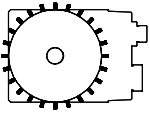
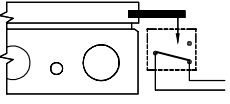
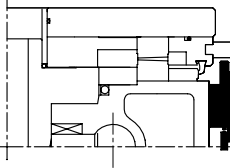
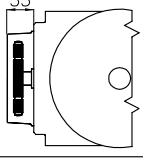
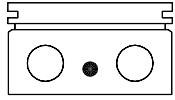
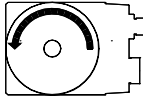
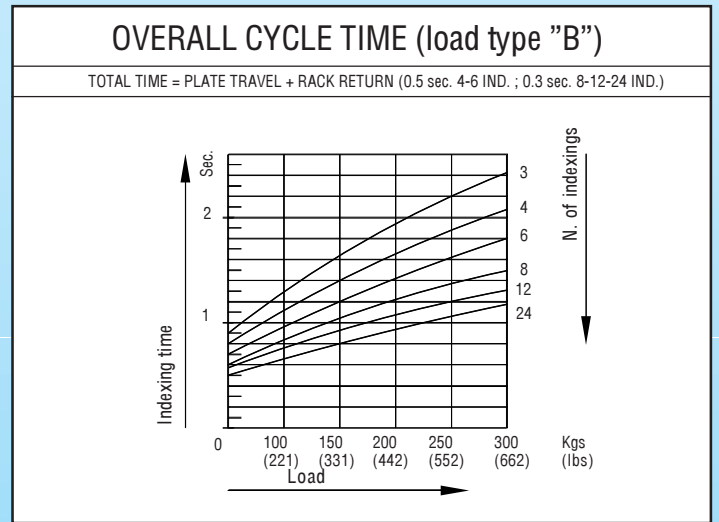
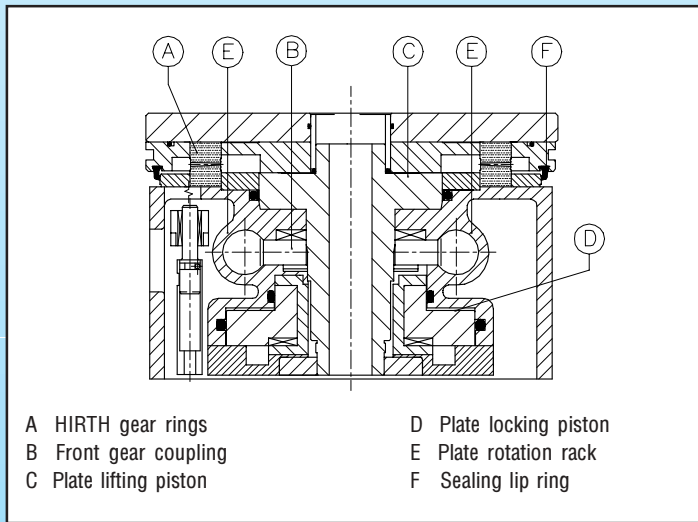

TABLE	CODE	INDEXINGS
QUICK STATION CHANGE		
T.HPE.350	10560010	3-4-5-6-8-10 12-15-20-24-30 40-60-120
Table is supplied set on your required number of indexings, Ex. 3-5-12-30-40-120		
STATION CHANGE WITH DISTANCE PIECES		
T.HPE.345	10560050	3-4-5-6-8-10 12-15-20-24-30 40-60-120
Table is supplied with one rack stop distance piece suitable for the selected n° of stations.		

ACCESSORIES	
PLATE POSITION PINS	CODE
	28020250
PLATE POSITION MICRO-SWITCH	CODE
	28020200
	

ACCESSORIES	
FITTED SOLENOID VALVE	CODE
	28020220
MANUAL START BUTTON	CODE
	28020210
COUNTER-CLOCKWISE ROTATION	CODE
	M9910050

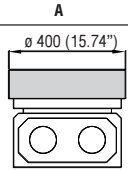
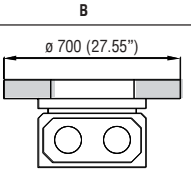
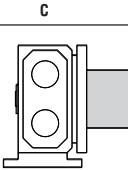

### LIMIT LOAD ON PLATE

A	B	C
		
400 Kgs (883 lbs)	250 Kgs (551 lbs)	120 Kgs (265 lbs)

### LIMIT STRESSES ON PLATE (6 bar)

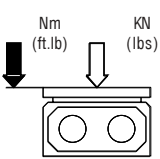
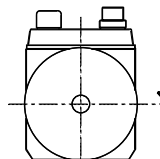
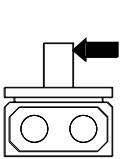
		
1400 Nm (1031 ft.lb) 30 KN (6623 lbs)	950 Nm (700 ft.lb)	600 Nm (442 ft.lb)

### MOMENT OF INERTIA CALCULATION

I = moment of inertia  $kgm^2$  (ft<sup>2</sup>.lb) - M = mass kg (lbs) - R-r,d = radius m (ft)

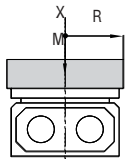
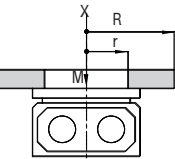
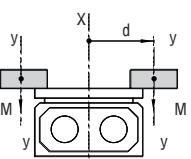
EVENLY DISTRIBUTED LOAD	RING TYPE LOAD DISTRIBUTION	FIXTURES LOADING
 $I = 1/2 \cdot M \cdot R^2$	 $I = 1/2 \cdot M \cdot (R^2 + r^2)$	 $I = M \cdot d^2 \cdot n^2$