



TENTUBE SERIES

Specifications

Pressure:

Vacuum to 100 psi, 6.9 bar per line

Temperature:

Acetal fitting inserts:
-40°F to 180°F (-40°C to 82°C)

Polypropylene fitting inserts:
32°F to 180°F (0°C to 82°C)

Materials:

Main components: Nylon

Valves: Acetal

Valve springs: 316 stainless steel

Fitting inserts: Acetal or polypropylene

O-rings: Buna-N with acetal
or EPDM with polypropylene

Panel mount adapter: Acetal

Tube shroud: Acetal

Color:

Main components:

Black with red locking latch

Tube shroud: Black

Panel mount adapter: Black

Tubing Sizes:

1/16" to 1/8" ID, 1.6mm to 3.2mm ID

Note: Use TMF and TFF inserts and bodies for custom designed assemblies. See page 69.

The Tentube™ coupling provides one easy-to-use quick disconnect for up to ten separate fluid lines. The Tentube is available with valves on the body side in panel mount or in-line configurations for maximum design flexibility. The Tentube can connect and disconnect up to ten lines with the use of a simple slide latch. Tubing orientation is ensured by keying the coupling body and insert. Different fluids and tubing sizes can be accommodated by using acetal or polypropylene inserts in three popular sizes.

Features

- Ten line connection
- Separate flow paths
- Insert is keyed to body
- Acetal or polypropylene inserts

Benefits

- Fast, efficient operation
- Pressure and/or vacuum in one coupling
- Ensures correct line orientation
- Maximize design flexibility

Panel Mount Dimensions

	PANEL OPENING	MAX. PANEL THICKNESS	MIN. PANEL THICKNESS
COUPLING BODIES	see drawing	.44	.06

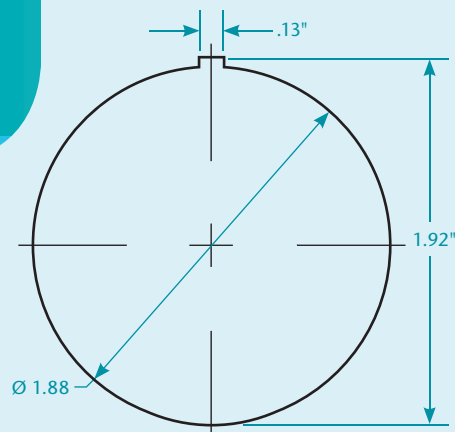

Tentube Air Flow, 100 psig Inlet Pressure

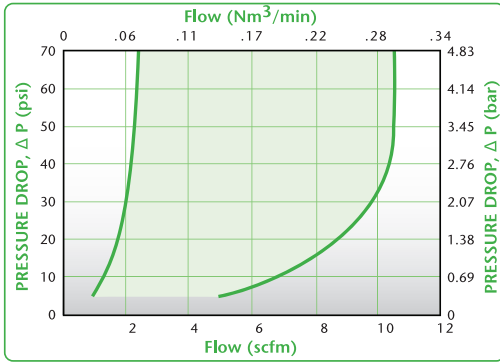

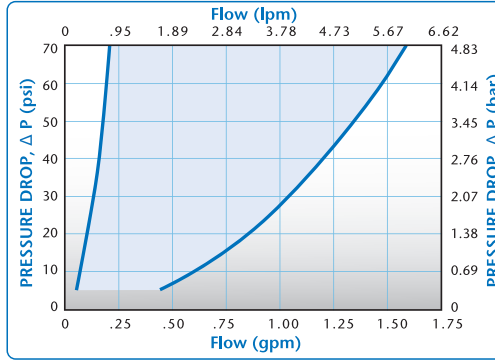

Tentube Water Flow



These graphs are intended to give you a general idea of the performance capabilities of each product line. The shaded area of each graph represents the operating range of the product family, i.e., upper and lower values are shown. Therefore, depending on the exact coupling configurations selected, you can reasonably expect values to fall within the shaded area.



Don't forget: you can always visit www.colder.com for more product information.

Tentube™ Complete ACETAL / POLYPROPYLENE

TERMINATIONS COMPLETE COUPLING SET	TUBING SIZE	METRIC EQ.	ACETAL STRAIGHT THRU	ACETAL SHUTOFF	POLYPROPYLENE STRAIGHT THRU	
	1/16" ID	1.6mm ID	TT1001	TTD1001	TT100112	
	3/16" ID	3.0mm ID	TT10M3	TTD10M3		
	1/8" ID	3.2mm ID	TT1002	TTD1002	TT100212	
TERMINATIONS COUPLING BODY WITH FEMALE FITTING BODIES	TUBING SIZE	METRIC EQ.	ACETAL STRAIGHT THRU	ACETAL SHUTOFF	POLYPROPYLENE STRAIGHT THRU	
	1/16" ID	1.6mm ID	TFB1001	TFBD1001	TFB100112	
	3/16" ID	3.0mm ID	TFB10M3	TFBD10M3		
	1/8" ID	3.2mm ID	TFB1002	TFBD1002	TFB100212	
	Without fitting bodies		TFB10			
TERMINATIONS COUPLING INSERT WITH MALE FITTING INSERTS	TUBING SIZE	METRIC EQ.	ACETAL STRAIGHT THRU		POLYPROPYLENE STRAIGHT THRU	
	1/16" ID	1.6mm ID	TMB1001		TMB100112	
	3/16" ID	3.0mm ID	TMB10M3			
	1/8" ID	3.2mm ID	TMB1002		TMB100212	
	Without fitting inserts		TMB10			

Inserts & Bodies

ACETAL / POLYPROPYLENE

TERMINATIONS FITTING INSERTS (SEE NOTE ON PAGE 68)	TUBING SIZE	METRIC EQ.	ACETAL STRAIGHT THRU		POLYPROPYLENE STRAIGHT THRU	
	1/16" ID	1.6mm ID	TMF01		TMF0112	
	3/16" ID	3.0mm ID	TMFM3			
	1/8" ID	3.2mm ID	TMF02		TMF0212	
TERMINATIONS FITTING BODIES (SEE NOTE ON PAGE 68)	TUBING SIZE	METRIC EQ.	ACETAL STRAIGHT THRU	ACETAL SHUTOFF	POLYPROPYLENE STRAIGHT THRU	
	1/16" ID	1.6mm ID	TFF01	TFFD01	TFF0112	
	3/16" ID	3.0mm ID	TFFM3	TFFDM3		
	1/8" ID	3.2mm ID	TFF02	TFFD02	TFF0212	

Note: Acetal bodies and inserts are also available in white. To order, add MWHT to the end of the part number.

Accessories

DESCRIPTION	PART NO.	
Tube shroud - snaps into either half	TS10	
Panel mount adapter & nut - 7/16" max. panel thickness; requires 1.875" diameter hole	TPM10	
Tube jacketing - black, 40 foot coils	TJ10	

All measurements are in inches (millimeters) unless otherwise noted. Tubing must meet stated inside and outside diameters. Couplings are pictured with valves unless otherwise noted.

COLDER SAFER TENTUBE SERIES